

A LIGHTING DESIGN CONCEPT
FOR A CAFE

(CUSTOMIZED AS A TEAHOUSE)

CONCEPT PRESENTATION

LINDA S KRUK
RESIDENTIAL INTERIOR LIGHTING DESIGN
PARSONS SCHOOL OF DESIGN

◀ KEYBOARD NAVIGATION ▶

TEA HOUSE



AN INTERNATIONAL TEA &
CONFECTIONARY DELIGHTS
ESTABLISHMENT

TEA HOUSE

A CONCEPT INSPIRED BY TRADITION



... AND BEAUTY

Tranquility, craftsmanship, architecture, material aesthetics –
all tantamount to the experience of –
- *the journey through tea to peace of the spirit*



TEA HOUSE

CHASHITSU – IT'S ALL ABOUT TEA ...



*An experience
Steeped in Tradition
and Aesthetics*

"The essence of the Japanese tea ceremony is reflected in its four main principles:

Wa Kei Sei Jaku

(harmony, respect, purity & tranquility)."

THIS IS THE *DESIGN CUE* FOR TEA HOUSE

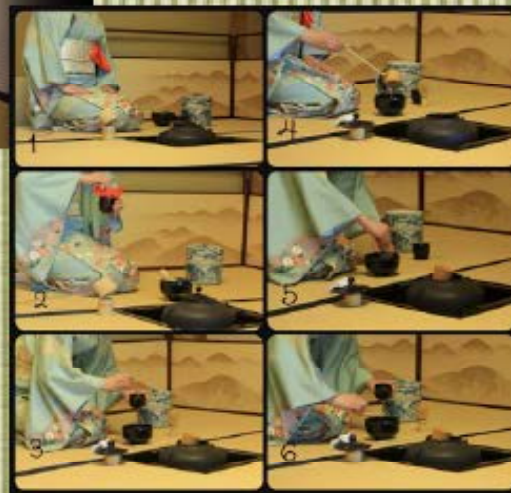



... AND SWEETS



SWEETS . . . INTEGRAL TO THE EXPERIENCE

Counter to our own culture, sweets are eaten first, before drinking the tea. The artistry of the presentation is as important as the flavor.



TEA HOUSE

THE INTERIOR DESIGN

DESIGN CONSIDERATIONS

- Hand Hewn wood, Post & Beam Construction
- The *Tatami* Mats are integral to the tea ceremony - driving the flooring layout & material decisions.
- Fire pits for heating water
- Multi-level table heights providing greatest visibility for a tea ceremony, and traditional/modern seating comfort for guests.
- Inclusion of *Tokonoma* (Alcove) for displaying a *Kakemono* - hanging scroll.
- Layered lighting; focal glow, ambient luminescence, play of brilliants



TEA HOUSE

VERSATILE CONFIGURABILITY

SIMPLICITY OF DESIGN

The beauty of Japanese design in general is in its minimalist simplicity and barrier free architecture – which lends itself to adapting a room to any configuration on the fly. Use of screens as partitions, or flowing fabrics hung from ceilings for example can dramatically alter a room's dynamic without adding structure.



TEA HOUSE

DRAMATIC FOCAL POINT

THE FIRE PIT

The suspension of a tea pot over a floor installed Fire Pit can be a dramatic focal point of the room.

Whether the pit is lit by fire while heating water or simply illuminated when it is not – lighting will bring it to life.



TEA HOUSE

THE COLOR PALETTE

INSPIRATIONS

The soothing palette will come from the natural materials used in construction and for serving (i.e.; Bamboo, Red Pine posts with bark, Grass Mats, Ceramic bowls and utensils) –the calming *foam of the Tea* itself, Matcha, complimented by the *sweet cakes* commonly eaten as a part of the experience, and *traditional ceremonial clothing*.

"SEI"
PURITY



"JAKU"
TRANQUILITY

TEA HOUSE

MATERIALS AND FINISHES

BLENDING OLD AND NEW

- Bamboo elements used in new ways
- Fire Pit for Heating the Tea Pot
- Shoji, scroll art work
- Multi-Level Seating and platforms
- Calming Sage Green Colors with small Red accents
- Layers of light:
 - Direct: Pinpoint Pendants
 - Indirect: Wall Washers, Baseboard, Cove
 - Spotlights for Ceremonial use
 - Natural: Skylight (motorized Shade)

"WA"
HARMONY



TEA HOUSE

IMPORTANT AREAS OF INTEREST

RESPECTING CEREMONIAL, TRADITIONAL, & DECORATIVE ELEMENTS THROUGH LIGHT

Every Tea Room has a *Tokonoma* (alcove) containing a hanging scroll. It is considered a place of honor to be seated near it.

Temaeza (Tea Master's Mat) – the center of the Ceremony

Shoji Screens/Doors – Beautiful, decorative, functional and movable!

Wall art - murals of gentle branches provide foliage in a room without windows

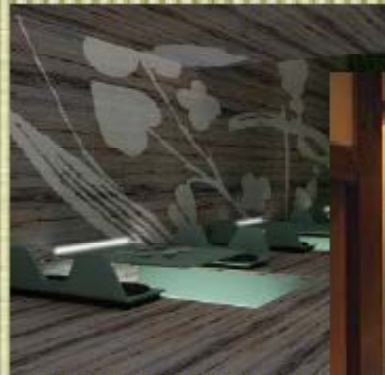

"KEI"
RESPECT



TEA HOUSE

DEFINING SMALL DETAILS

CEREMONIAL DETAILS

- The *Chashitsu* (Tea Ceremony) is essential to the Tea House. The area designated for its performance is called *Temaeza* (Tea Master's Mat).
- Fire Pit – source of practical heat as well as architecturally interesting
- Chabana – flowers are typically placed throughout the room
- Greenery - Providing a placid, tranquil, organic feel to the space.



TEA HOUSE

LIGHTING FIXTURE AESTHETICS

LIGHTING DESIGN WILL EMPLOY:

LAYERING

- Direct: Pinpoint Pendants
- Indirect: Wall Washers, Baseboard, Cove
- Spotlights: Ceremonial use
- Natural: Frosted Skylight



LIGHTING FIXTURES WILL EMPLOY MATERIALS FROM:

NATURAL, UNFINISHED WOODS

- Bamboo
- Red Oak
- Sepele



TEA HOUSE

ILLUMINATING TABLETOPS



TABLESCAPES AS ARCHITECTURE

Each element on the table has value and interest,
Part of the journey of Tea and spirit.

TEA HOUSE

ILLUMINATING SHOJI PANELS



SOFT DIFFUSED
LIGHT:
With purpose

Creating a sense of
things implied

*Foliage
Sun
Structures*

Or represented
as Art



TEA HOUSE

SHOWCASING ARCHITECTURAL AESTHETICS



TEA HOUSE

FEEL THE ROOM - THROUGH LIGHT



ACCENTUATING

- ◆ TEXTURES

CREATING

- ◆ INTIMATE SPACES

INTEGRATING

- ◆ PRACTICAL INDIRECT FEATURES

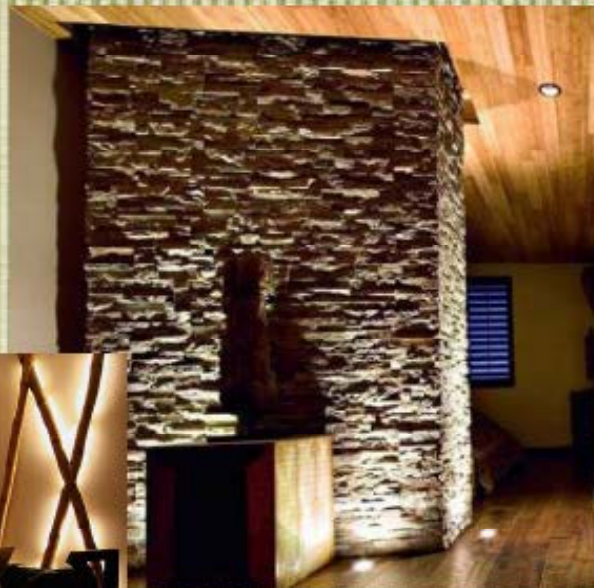



SAFETY MEETS AESTHETICS



INTEGRATING:

- PRACTICAL NECESSITY
- SAFE PASSAGE FROM SPACE TO SPACE

RESPECTING:

- AMBIENCE
- AESTHETICS

TEA HOUSE

ELEMENT DESIGN AESTHETIC

**A TRADITIONAL FEEL –
WITH A MODERN LOOK**

Not only furniture, architecture, and lighting – but the table elements will have an “old world” feel, but with a modern aesthetic.





OVERALL EFFECT: SUBLIME

FULLFILLMENT
OF THE 4
TENETS OF
TEA

WA
Harmony

KEI
Respect

SEI
Purity

JAKU
Tranquility





“DŌMO ARIGATŌGOZAIMASHITA”



どうもありがとうございました
THANK YOU VERY MUCH